



PERFORMANCE • VALUE • SERVICE

988
COMMERCIAL/INDUSTRIAL GRADE

ROLL UP DOORS



Features

- Strong, Heavy-Duty Materials
- Smooth, Quiet Operation
- Custom Sizes
- 977WL Withstands Higher Wind Loads
- Low Maintenance
- Minimal Back Room Requirements

- Commercial Applications
- Motor Operator Applications
- Rust Resistant
- 30/25 Yr Paint
- 3 Yr Material/Craftsmanship
- 10 Yr Spring Warranties

Commercial Grade Performance

Trac-Rite's model 988 delivers performance day in and day out. In sizes up to 16' wide. Our model 988 door was designed to be the heavy-duty solution for large door openings. These doors are designed with features for long life such as the EP3 coated spring, which resists rust and requires no lubrication. An optional chain hoist system allows for effortless operation for larger door openings, and extra wide felt strips on the back of the door provide smooth operation for decades.

Our model 988 door was designed to be the heavy-duty solution for large door openings. The pre-installed SpaceGuard latch accepts two padlocks and an optional cylinder lock. The doors are available in wide variety of standard colors all at one great price. Our leading edge manufacturing techniques provide consistent quality with a high degree of efficiency.

Trac-Rite takes customer service seriously. We are 100% employee-owned. Every employee has a vested interest in serving our customers. Whether you are interacting with one of our resellers or directly with us, you'll receive prompt responses and knowledgeable assistance.

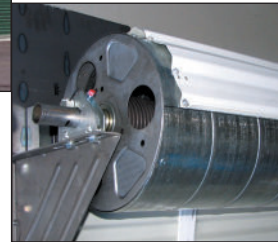

Dead-axle design with torque-tube assembly allows the door to operate with ease.



As wind blows against the 988WL, the curtain's windlocks engage with the door guide for a strong interlocking grip. This grip keeps the curtain securely in the guide.

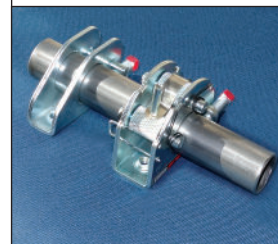

Saddle with tensioner device makes adjusting the door tension easier, safer, and quicker than clamp and bracket designs.



Chain hoist mounts directly to the axle for easy installation. 8:1 reduced-drive allows for smooth operation.



Dual 12-gauge, zinc-coated interior steel latches slide into door guide brackets. Latches may also be padlocked for added security.

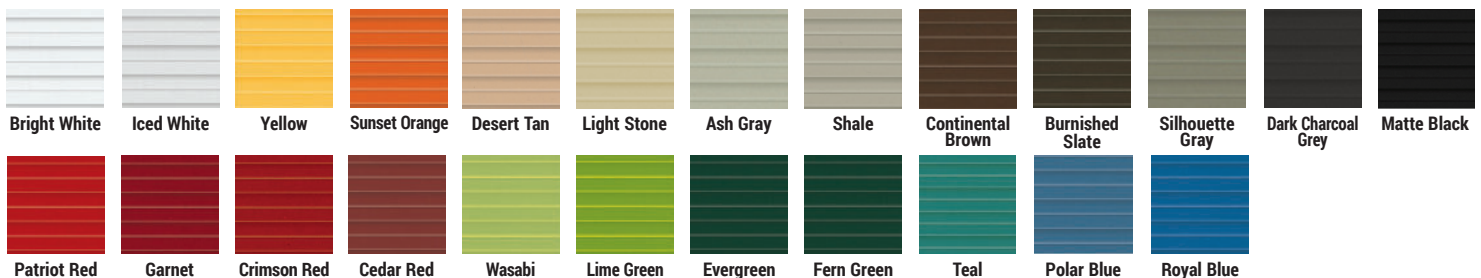

Colors vary from actual panel material. Please request a steel color sample for precise shade.

988

ROLL UP DOORS



Mounting Surface & Door Clearance Requirements

Measure the following areas to design a 988 or 988WL door to your specific needs.

Framed Opening

Measure the framed opening.

A = Width
' ___ "

B = Height
' ___ "

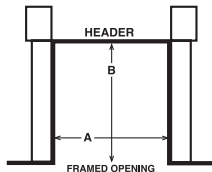

The 988 and 988WL doors are available in custom sizes from 10'W x 8'H to 16'W x 16'H in 1" increments.

FOR EXAMPLE: If your framed opening is 14'6" wide and 16'0" high, you would order a 14'6" x 16'0" (width first, height second) door.

Mounting Surfaces

Measure the mounting surface areas.

NOTE: All mounting surfaces must be flush.

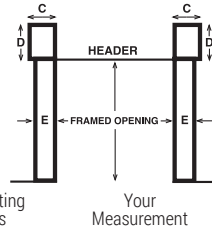

Brackets	Minimum Mounting Surface Areas	Your Measurement
C = Width	5"	' ___ "
D = Height	13"	' ___ "
Guides		
E = Width	3" (5" masonry jambs)	' ___ "

Door Clearance

Measure the door clearance.

NOTE: Insulated doors require an additional 1" of back room and head room.

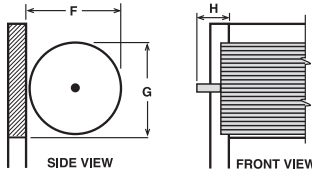

	Minimum Clearance	Your Measurement
F = Back Room	988 = 20" / 988WL = 21"	' ___ "
G = Head Room	988 = 22" / 988WL = 23"	' ___ "
H = Side Room	988 / 988WL = 8 1/4" (22" for motor operator)	' ___ "

Accessories

- Jamb Brush Seal
- Header Draft Stop
- Exterior SpaceGuard Latch
- SpaceGuard Cylinder Lock
- Insulation
- Hood
- Commercial Grade Motor Operator
- Third Party Latches
- Interior Latches
- Insulation



Wind Load Ratings

Tested and certified by an independent lab.

988WL Door Width	988WL PSF Rating
10'0"	32.0/197
11'0"	32.0/198
12'0"	29.0/189
13'0"	24.0/172
14'0"	24.0/173
15'0"	21.0/162
16'0"	21.0/163

Exposure based on Category B.

*MPH rating represents wind speed per the International Building Code (IBC), Exposure B. Actual allowable wind speed may vary based on actual site conditions and application.

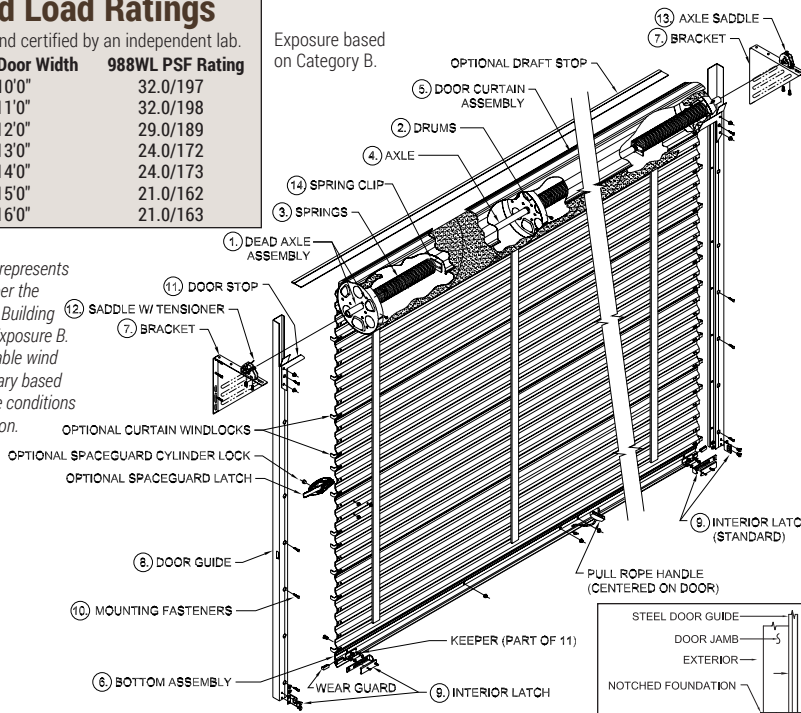

** 2 PIECE GUIDES STANDARD ON ALL DOORS TALLER THAN 14' 10"

Floor offset recommended to prevent water migration.

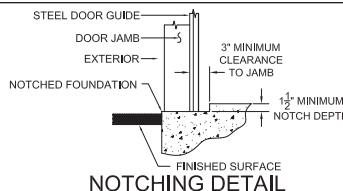

Specifications

DESIGN TYPE Dead-axle design with torque-tube assembly. Rotates on a fixed axle during operation.

TORQUE-TUBE ASSEMBLY Axle is high-yield structural tubing with 1-5/16" outside diameter. Drums are 12" diameter spiral x 1-1/2" wide, 16-gauge, zinc-coated steel with grease-filled ball bearings mounted in the center of the drum to promote smooth operation. Springs are helical torsion, oil tempered, and factory lubricated to increase life cycle. Axle, drums, and springs are enclosed in a 26-gauge galvanized spiral tube to provide even curtain support.

CURTAIN Roll-formed sections, factory seamed from 26-gauge, Grade 80 galvanized steel. Silicized polyester finish in sixteen standard colors. Full-length 2" felt tape for smooth rolling and reduced marring.

BOTTOM ASSEMBLY Seal-Rite pliable bulb and blade astragal integrated into galvalume bottom bar with stiffening angle.

BRACKETS Universal mounting brackets are interchangeable for mounting on the left or right side. 10-gauge, cold-formed, galvanized steel, embossed for added strength.

SADDLE WITH TENSIONER Easily adjustable one-piece saddle accepts 1-5/16" diameter axle. Double cams lock the axle in position and maintain tension on the springs.

GUIDES 16-gauge, zinc-coated, 2-3/4" deep. Featuring polypropylene guide runners to assure smooth operation and prevent steel-on-steel contact.

988WL CURTAIN WINDLOCKS 10-gauge, zinc-coated steel, secured to door with two 3/16" rivets.

988WL WINDLOCK BAR Galvanized, 12-gauge, with holes for fastening to jamb every four inches. Placed inside the guide.

CHAIN HOIST 8:1 reduced-drive. Mounts directly to the axle on either the left or right side.

INTERIOR LATCHES 12-gauge, zinc-coated steel slide bolt engages a lock strike attached to the side guide. Two latches per door fasten to the bottom assembly and are suitable for padlocking.

MOUNTING FASTENERS Steel or wood fasteners included. For masonry openings, mounting clips and anchoring system are sold separately.

DOOR STOP 12-gauge, zinc-coated, L-shaped door stops. Mount to guides.

Product specifications are subject to change without notice.



For more information

PHONE 800.448.8979
 FAX 800.236.8722
 WEBSITE www.tracrite.com
 EMAIL tr@tracrite.com
 ADDRESS 314 Wilburn Road
 Sun Prairie, WI 53590